

News Release

April 4, 2016

drupa 2016

Tuesday, May 31 to Friday, June 10, 2016
Düsseldorf Fairgrounds HALL 15 D04

drupa 2016
KOMORI Theme
OPEN NEW PAGES



OPEN NEW PAGES

Komori Corporation (Head Office: Sumida-ku, Tokyo, Japan; Representative Director, President and COO: Satoshi Mochida) will exhibit at drupa 2016. The following is an outline of the Komori booth.

For further information:
Komori Corporation
Solution Business Promotion Department
Yosuke Fujimaki, Manager
Tel +81-3-5608-7806
Fax +81-3-3624-9519

drupa 2016

Dates: Tuesday, May 31 to Friday, June 10, 2016
Venue: Düsseldorf Fairgrounds HALL 1-17
Komori booth: HALL 15 D04

drupa 2016 will be held in Düsseldorf, Germany, for eleven days, Tuesday, May 31 to Friday, June 10, 2016.

Komori Corporation will exhibit under the theme 'OPEN NEW PAGES' at drupa 2016.

Through the technologies and solutions presented in the Komori booth, we will show our commitment to becoming the business partner of customers that is capable of improving their margins and increasing their productivity.

Greetings

Komori overcame the global recession that followed the collapse of Lehman Brothers through structural transformation and business model innovation, and the business model of the new Komori was unveiled at IGAS 2015. And the upcoming drupa 2016 will be Komori's most important business activity this fiscal year.

First of all, Komori's main theme at drupa 2016 will be "Open New Pages," a continuation from IGAS 2015. We will propose new business models by connecting customers with Komori, linking offset with digital, and connecting the management factors related to printing plant production and quality. For this purpose, "Connected Print" will be our subtheme. We will convert the achievements of the structural transformation and business model innovation in sales activities shown at IGAS into solutions and ideas for customers to Open New Pages and show them at drupa.

Second, in digital printing systems, drupa will begin regular sales of the Impremia IS29, our inkjet UV printing system, jointly developed with Konica Minolta. The Open New Pages Show at the Komori Graphic Technology Center (KGC) this February attracted nearly 400 customers. Open house events were also held at Komori America Corporation this February and Komori International (Europe) B.V. in March, and the ability to print directly on a wide variety of stocks and the high print quality impressed attendees and many inquiries were received. At drupa, Komori will show our unique and original solutions. And we will demonstrate the innovative B1-size Impremia NS40 digital printing system that uses in-the-spotlight nano technology under license from Landa Corporation. This new product will perform high-speed printing at 6,500 sph as the world's first B1 digital printing system. We believe that visitors will experience the technical innovations and performance improvements that have been made in the four years since Landa announced the system at drupa 2012.

Third, we will release the new Lithrone G29 29-inch offset printing press. The design has been renovated, and the press has been reborn as a high-end machine meeting the printing needs of increasingly advanced and complex markets. In the future, this base machine will be developed into a system with productivity surpassing digital printing systems. Also, the Lithrone GX40RP equipped with the latest technologies will show the ultimate short makeready using parallel control and high productivity of 18,000 sph printing, while the Lithrone GX40 with coater will demonstrate new printing control and a high-precision print inspection system that enable high-speed package printing. All offset presses will be equipped with the H-UV innovative curing system and demonstrated using K-Supply H-UV ink. We intend to make drupa an opportunity to strengthen sales of

K-Supply products in Europe.

Fourth, we will exhibit the Apressia CT137 cutter as a part of our PESP business. We will demonstrate cutting of printed sheets that have been cured by the H-UV system and finishing as final products. Further, we will propose Komori ICT (Information Communications Technology) Solutions, a powerful tool supporting the visualization and automation of processes, labor saving, and productivity enhancement. These consist mainly of KP-Connect, for simple visualization of operating conditions over the cloud anytime and anywhere, and K-Station 4, for optimum scheduling of all presses.

Komori will start a new medium-term Management Plan this April, and continue to not only transform the business structure but also positively promote business model innovation in sales activities and the PESP business. The plan calls for “change” to be completed within the next three years. drupa is the stage for new product development, and we will continue to clearly communicate Komori’s product development achievements to everyone in the printing industry at this show and IGAS. Under our main theme of “Open New Pages,” we will make proposals for customers to open new pages as a total solution provider.

Looking ahead, we thank you and sincerely ask for your continued support and encouragement.

Yours sincerely

Satoshi Mochida
Representative Director, President and COO
Komori Corporation
April 4, 2016

= Theme =

Komori drupa 2016 Theme “OPEN NEW PAGES” Subtheme “Connected Print”

Expanding the new potential of printing and realizing richer print communications — that’s what Komori and its customers are looking for.

Komori is evolving.

Komori is evolving from a specialist printing press manufacturer to a print engineering service provider (PESP). By presenting all solutions, we will expand the new potential of printing by offering offset, digital, printed electronics (PE), materials and auxiliary equipment.

Further, Komori will evolve in innovative ways with “Connected Print.” New value arises if all things and functions are linked by Connected Print. New value and solutions are created and richer print communications come about by connecting offset and digital, hardware and software as well as all printing tasks, and then linking customers and Komori in the cloud.

At the drupa 2016 Komori booth, we will have a range of ideas for customers to open new pages in different business settings, such as moving to high added value printing or digital printing for new growth or aiming to become a print media enterprise. By all means, come see how you can open new pages.

= KOMORI Booth =

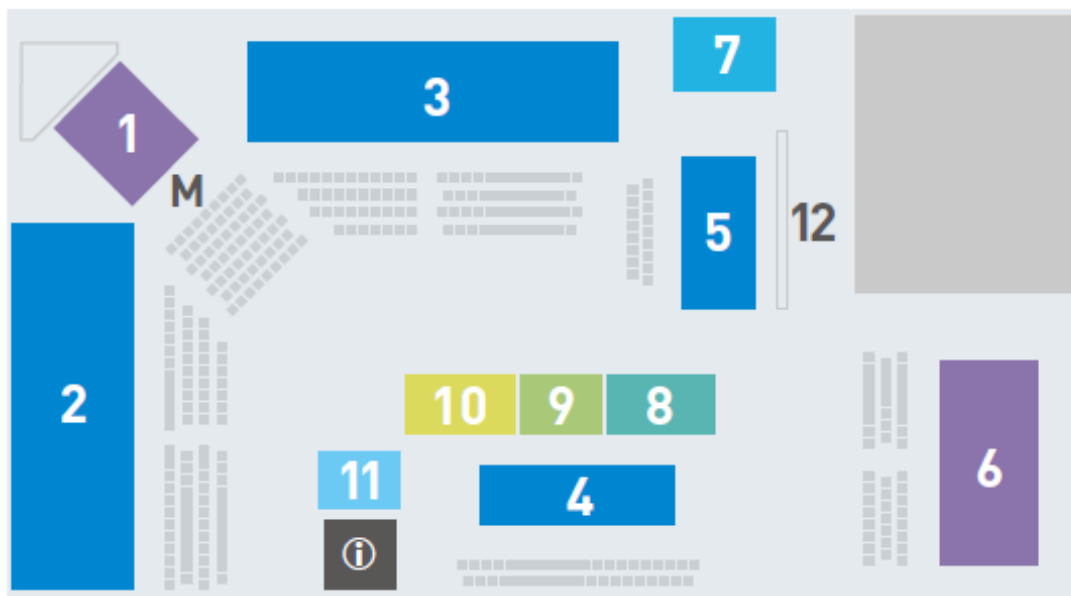

1 Impremia IS29 **NEW**

2 LITHRONE GX40RP (GLX-840RP)

3 LITHRONE GX40 (GLX-640+C)

4 LITHRONE G29 (GL-529+C) **NEW**

5 LITHRONE G37 (GL-437) **NEW**

6 Impremia NS40 **NEW**

7 Apressia CT137 **NEW**

8 KOMORI Ecology Corner

9 K-Supply / Service Corner

10 Web Offset / Chambon Corner

11 KOMORI ICT Solutions

12 Print Gallery

M Main Theater

① Reception

*Booth layout and exhibit content are subject to change without notice.

= Exhibit Machines and Outline =

1. Exhibit Machines

LITHRONE GX40	H-UV-equipped Six-color 40" Offset Printing Press with in-line coater												
<p>The ideal 40-inch press for package printing and special printing Offering a sheet thickness range of 0.06–1.0 mm, this press provides very stable operation at the 18,000 sph maximum printing speed thanks to new sheet feeding and delivery performance. The new automatic ink roller washing system significantly improves color changing, which is a bottleneck in printing with special colors. The exhibit machine will be shown with the PDF Comparator System*, the Sheet Numbering System*, and the automatic mask creation software* for powerful backup in packaging applications. * Options</p> <p>PDF Comparator System The PDF Comparator System reads the printed image using image sensors and enables comparison with prepress data. This enables checking for missing printed characters in the initial printing stage and prevents production losses and the outflow of defective sheets.</p> <p>Sheet Numbering System/Automatic Mask Creation Software The Sheet Numbering System prints a serial number above the feeder board and enables reliable checking of printing defects and waste sheets as well as enhanced quality control (traceability). In addition, by linkage with the Automatic Mask Creation Software, which automatically creates the inspection area from the die-cutting data in advance, quality control in units of blanks becomes possible.</p> <p>■ Demonstrations</p> <ul style="list-style-type: none"> ·High added value package printing on heavy stock ·Printing with H-UV instant curing and high added value printing with K-Supply varnish and special color inks ·Demonstration of PQA-S Print Quality Assessment System, Sheet Numbering System and PDF Comparator System ·Demonstration of printing task control by KP-Connect and K-Station 4 													
<p>【Basic specifications】</p> <table> <tr> <td>Model</td><td>GLX-640+C</td></tr> <tr> <td>Printing speed</td><td>18,000 sph</td></tr> <tr> <td>Max. sheet size</td><td>750 mm×1,050 mm</td></tr> <tr> <td>Max. printing area</td><td>740 mm×1,040 mm</td></tr> <tr> <td>Sheet thickness</td><td>0.06 mm～1.0 mm</td></tr> <tr> <td>Plate size</td><td>911 mm×1,055 mm</td></tr> </table>		Model	GLX-640+C	Printing speed	18,000 sph	Max. sheet size	750 mm×1,050 mm	Max. printing area	740 mm×1,040 mm	Sheet thickness	0.06 mm～1.0 mm	Plate size	911 mm×1,055 mm
Model	GLX-640+C												
Printing speed	18,000 sph												
Max. sheet size	750 mm×1,050 mm												
Max. printing area	740 mm×1,040 mm												
Sheet thickness	0.06 mm～1.0 mm												
Plate size	911 mm×1,055 mm												

LITHRONE GX40RP	H-UV-equipped Eight-color 40" Front/Reverse Multi-Color Offset Printing Press												
<p>One-pass double-sided press that extends the OffsetOnDemand world</p> <p>State-of-the-art dedicated double-sided press for OffsetOnDemand printing. Maximum printing speed is 18,000 sheets per hour. Revolutionary technologies employed throughout. One-pass double-sided configuration with no sheet reversal helps reduce paper cost since the sheet size can be minimized because the margin on the tail edge of the sheets is not necessary. Leading-edge short makeready and printing with H-UV instant curing make the press capable of handling very small lots and short turnarounds. Ideal for the increasing demand for package printing with double-sided multi-color printing.</p> <p>■ Demonstrations</p> <ul style="list-style-type: none"> ·16-page A4-size catalog printing ·High quality gang-run printing ·Demonstration of printing task control by KP-Connect and K-Station 4 ·Demonstration with K-Supply ink 													
<p>【Basic specifications】</p> <table> <tr> <td>Model</td><td>GLX-840RP</td></tr> <tr> <td>Printing speed</td><td>18,000 sph</td></tr> <tr> <td>Max. sheet size</td><td>750 mm×1,050 mm</td></tr> <tr> <td>Max. printing area</td><td>740 mm×1,040 mm</td></tr> <tr> <td>Sheet thickness</td><td>0.04 mm~0.5 mm</td></tr> <tr> <td>Plate size</td><td>811 mm×1,055 mm</td></tr> </table> <p>※The 18,000 sph specification press will be on sale after drupa 2016.</p>		Model	GLX-840RP	Printing speed	18,000 sph	Max. sheet size	750 mm×1,050 mm	Max. printing area	740 mm×1,040 mm	Sheet thickness	0.04 mm~0.5 mm	Plate size	811 mm×1,055 mm
Model	GLX-840RP												
Printing speed	18,000 sph												
Max. sheet size	750 mm×1,050 mm												
Max. printing area	740 mm×1,040 mm												
Sheet thickness	0.04 mm~0.5 mm												
Plate size	811 mm×1,055 mm												

NEW LITHRONE G37	H-UV L (LED) -equipped Four-color 37" Offset Printing Press												
<p>Compact yet capable 37" press</p> <p>A compact press that can produce A1-size products, the Lithrone G37 offers a 640 x 940 mm maximum sheet size that can accommodate a wide range of printing needs. Perfect for a wide range of needs in publishing and commercial printing using either light or heavy stock due to printing with the H-UV L (LED) instant curing system. Since color management can be implemented by including a CMS color bar on sheets even with 8-up A4 and American letter size impositions, this machine is ideal for producing high page count products with high print quality.</p> <p>■ Demonstrations</p> <ul style="list-style-type: none"> · Work and turn printing of A4-size pamphlet on light stock with 8-up imposition · High quality single-side printing on heavy stock · Demonstration of high precision color control · Printing with H-UV L (LED) instant curing · Demonstration of printing task control by KP-Connect and K-Station 4 · Introduction of K-Supply products 													
<p>【Basic specifications】</p> <table> <tr> <td>Model</td><td>GL-437</td></tr> <tr> <td>Printing speed</td><td>15,000 sph</td></tr> <tr> <td>Max. sheet size</td><td>640 mm×940 mm</td></tr> <tr> <td>Max. printing area</td><td>620 mm×930 mm</td></tr> <tr> <td>Sheet thickness</td><td>0.04 mm~0.6 mm</td></tr> <tr> <td>Plate size</td><td>700 mm×945 mm</td></tr> </table> <p>※ Scheduled to be on sale after drupa.</p>		Model	GL-437	Printing speed	15,000 sph	Max. sheet size	640 mm×940 mm	Max. printing area	620 mm×930 mm	Sheet thickness	0.04 mm~0.6 mm	Plate size	700 mm×945 mm
Model	GL-437												
Printing speed	15,000 sph												
Max. sheet size	640 mm×940 mm												
Max. printing area	620 mm×930 mm												
Sheet thickness	0.04 mm~0.6 mm												
Plate size	700 mm×945 mm												
<p>NEW H-UV L (LED) NEW LED</p> <p>Since introducing the H-UV Innovative Curing System in 2009, Komori has shipped more than 600 H-UV-equipped presses. Now LED joins the lineup. The new LED version of H-UV will debut at drupa 2016 in live demonstrations on the new four-color Lithrone G37.</p>													

NEW LITHRONE G29	H-UV-equipped Five-color 29" Offset Printing Press with in-line coater												
<p>29" press meeting critical and complex needs at a high level.</p> <p>Maximum printing speed of 16,500 sph with superb high-speed stability even on heavy stock. Capable of the high quality printing that is a perfect match for H-UV printing, which is in increasing demand. Moreover, by equipping the press with the latest systems and automatic devices, it provides short makeready and reduced total lead time and flexibly meets demand for a range of high added value printing.</p> <p>■ Demonstrations</p> <ul style="list-style-type: none"> · Postcard printing on heavy stock · Cutting by Apressia CT137 · Poster printing · Demonstration of printing task control by KP-Connect and K-Station 4 · Demonstration with K-Supply ink 													
<p>【Basic specifications】</p> <table> <tr> <td>Model</td><td>GL-529+C</td></tr> <tr> <td>Printing speed</td><td>16,500 sph</td></tr> <tr> <td>Max. sheet size</td><td>530 mm×750 mm</td></tr> <tr> <td>Max. printing area</td><td>520 mm×740 mm</td></tr> <tr> <td>Sheet thickness</td><td>0.04 mm~0.6 mm</td></tr> <tr> <td>Plate size</td><td>605 mm×760 mm</td></tr> </table> <p>※ Scheduled to be on sale after drupa.</p>		Model	GL-529+C	Printing speed	16,500 sph	Max. sheet size	530 mm×750 mm	Max. printing area	520 mm×740 mm	Sheet thickness	0.04 mm~0.6 mm	Plate size	605 mm×760 mm
Model	GL-529+C												
Printing speed	16,500 sph												
Max. sheet size	530 mm×750 mm												
Max. printing area	520 mm×740 mm												
Sheet thickness	0.04 mm~0.6 mm												
Plate size	605 mm×760 mm												

NEW Apressia CT137	Programmable Hydraulic Clamp Cutter												
<p>Komori cutter with up-to-date safety features and ease of use</p> <p>Komori's first lineup of postpress equipment will be represented by the Apressia CT137 Programmable Hydraulic Clamp Cutter. Stringent safety standards, ease of operation and versatility, with outstanding productivity and cost performance.</p>													
<p>【Basic specifications】</p> <table> <tr> <td>Table width</td><td>2,900 mm</td></tr> <tr> <td>Table height</td><td>900 mm</td></tr> <tr> <td>Maximum cutting height</td><td>165 mm</td></tr> <tr> <td>Cutting width</td><td>1,370 mm</td></tr> <tr> <td>Cutting length</td><td>1,450 mm</td></tr> <tr> <td>Clamp load</td><td>1,500~45,000 N (153~4,589 kgf)</td></tr> </table>		Table width	2,900 mm	Table height	900 mm	Maximum cutting height	165 mm	Cutting width	1,370 mm	Cutting length	1,450 mm	Clamp load	1,500~45,000 N (153~4,589 kgf)
Table width	2,900 mm												
Table height	900 mm												
Maximum cutting height	165 mm												
Cutting width	1,370 mm												
Cutting length	1,450 mm												
Clamp load	1,500~45,000 N (153~4,589 kgf)												

NEW Impremia IS29	29" Sheetfed UV Inkjet Digital Printing System										
<p>Quality, reliability and stability in an advanced digital printing system</p> <p>The Impremia IS29 is a state-of-the-art digital printing system with a maximum sheet size of 585 x 750 mm. Capable of printing on ordinary offset printing paper, the Impremia IS29 is suitable with a wide range of stocks.</p> <p>In addition, the printing unit incorporates Komori offset press manufacturing technologies, resulting in excellent tone reproduction and register accuracy and realizing high quality printing that approaches offset. This suitability with stocks and high print quality brings about the fusion of offset and digital and enables the ideal seamless combination of equipment.</p> <p>Also, by taking advantage of UV inkjet characteristics, the system is ideal for not only commercial printing but also package printing. At drupa, Komori will demonstrate double-sided printing on heavy stock and propose new business models that extend through a linkup with digital finishing equipment.</p> <p>With added value such as variable and wide color gamut printing, the Impremia IS29 not only supports small lots of many different items and short turnarounds but also brings great advantages in the accelerating digital printing business.</p> <p>■ Demonstrations</p> <ul style="list-style-type: none"> ·Color matching with offset using the same stock and image by means of K-ColorSimulator 2 ·Variable data book printing ·Variable poster printing with three types of stock, each printed with three images ·Wide color gamut printing coverage with CMYK inks ·Printing of presentation folders on heavy stock ·Demonstration of printing task control by KP-Connect and K-Station 4 ·Display of diverse printing samples 											
<p>【Basic specifications】</p> <table> <tr> <td>Resolution</td><td>1,200 × 1,200 dpi</td></tr> <tr> <td>Printing speed</td><td>3,000 sph (single-sided) 1,500 sph (double-sided)</td></tr> <tr> <td>Max. sheet size</td><td>585 × 750 mm</td></tr> <tr> <td>Max. printing area</td><td>575 × 735 mm (single-sided), 575 × 730 mm (double-sided)</td></tr> <tr> <td>Sheet thickness</td><td>0.06–0.6 mm (single-sided), 0.06–0.45 mm (double-sided)</td></tr> </table>		Resolution	1,200 × 1,200 dpi	Printing speed	3,000 sph (single-sided) 1,500 sph (double-sided)	Max. sheet size	585 × 750 mm	Max. printing area	575 × 735 mm (single-sided), 575 × 730 mm (double-sided)	Sheet thickness	0.06–0.6 mm (single-sided), 0.06–0.45 mm (double-sided)
Resolution	1,200 × 1,200 dpi										
Printing speed	3,000 sph (single-sided) 1,500 sph (double-sided)										
Max. sheet size	585 × 750 mm										
Max. printing area	575 × 735 mm (single-sided), 575 × 730 mm (double-sided)										
Sheet thickness	0.06–0.6 mm (single-sided), 0.06–0.45 mm (double-sided)										

NEW

Impremia NS40

40" Sheetfed Nanographic Printing® System

Digital printing system based on revolutionary system using nano pigments

The Impremia NS40 is a digital printing machine born from a new revolutionary system that uses the Nanographic Printing® process, or Nanography®. This is an innovative system and printing process that employs Landa NanoInk® colorants, a proprietary water-based ink with nano-pigment particles that measure tens of nanometers in size.

The Nanographic Printing® process begins with the jetting of billions of droplets. However the droplets are not ejected directly onto the substrate. Instead, they are ejected onto a blanket from ink ejectors.

As each ink droplet lands on the heated blanket, it spreads and very quickly loses its water, becoming thinner as it does so. When all of its water has been evaporated, the ink becomes an ultra-thin, dry polymeric film on the blanket.

When pressed into contact with the printing substrate upon transfer, this thin 500 nm layer of ink instantaneously bonds tenaciously to the substrate without penetrating it. The formed images are tough, abrasion resistant, do not need post-drying and leave no residual ink on the blanket.

Can be used with all common commercial substrates (coated and uncoated paper, paperboard, plastic and specialty substrates).

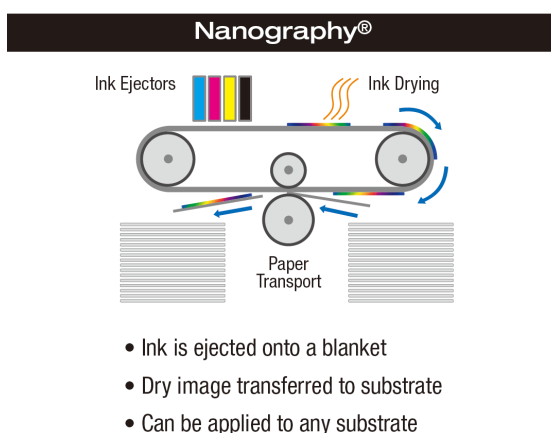

■ Features of ImpremiaNS40

1. High speed digital printing
 - High throughput with 6,500sph
 - Various substrates availability w/o primer
 - Similar print quality with offset press
2. Wide color gamut and fine print quality with Nanographic Printing® System
 - Wide color gamut coverage with CMYK (covering 71% of Pantone)
 - Maximum 7 colors available (+OGB)
 - Very thin ink film with Nano-ink
3. High speed digital integrated with offset printing
 - Fusion of Komori and Landa technologies
 - Fastest B1 size digital press with 1200x1200dpi
 - Chamber coater system available
 - Line up of duplex printing configuration

【Basic specifications】

Number of colors	4 (C/M/Y/K: Landa Nano Ink®)
Resolution	1,200 × 1,200 dpi
Printing speed	6,500sph
Max. sheet size	750 × 1,050 mm
Sheet thickness	0.06–0.8 mm

2. KOMORI ICT Solutions

Komori ICT (Information Communications Technology) Solutions is the general name for solutions that only Komori as a press manufacturer could develop as powerful support for improving printer productivity. These solutions use the latest ICT and connect print manufacturing processes to make them visible, automatic and labor saving.

NEW KP-Connect	Komori Solution Cloud
--------------------------	-----------------------

State of printing operations made visible via the cloud

KP-Connect is a service that improves productivity by allowing the printing company and Komori to share detailed press operating information in the safe environment of the cloud, making printing operations visible in real time. A platform supporting stable, efficient and high quality production that is not dependent on the individual skill of the operator by providing data-based, advanced know-how from Komori as well as the printer's own improvements.

■ Features

- Able to check pressroom productivity on a mobile device.
- Enables immediate response to abnormality in plant by informing supervisor.
- Real time simulation of production cost per job
- Allows analysis of monthly operating state and discussion of improvements.
- Operator can check standard working time as well as printing and maintenance procedures on tablet.
- Allows analysis of operating state and presentation of improvements.

NEW K-Station 4	Printing Task Control Software
---------------------------	--------------------------------

Scheduling and workflow automation for all presses

As an interface connecting MIS and the presses, K-Station 4 digitizes and streamlines printing task control. In addition, automation of prepress and postpress is available as an advanced option*. *Technical exhibit at drupa 2016

■ Features

- Able to check pressroom productivity on a mobile device.
- Enables scheduling while viewing printing progress. No need to input twice due to link with MIS.
- Operation with fewer personnel possible by automation of prepress and postpress.
(Multi-skill development)

NEW K-ColorSimulator 2	Easy Color Matching Software
----------------------------------	------------------------------

High-level color matching of offset and digital

K-ColorSimulator 2 is the core Komori color management system for reproducing offset printing/ISO color with output devices.*

* Epson Inkjet Proofer, Impremia C Series and Impremia IS29

■ Features

- Easy color matching offset and digital printing.

3. Corner Exhibition

K-Supply/Service Corner

Under the K-Supply brand name, Komori offers a lineup of special consumables, materials and equipment that are standard for Komori-made presses. K-Supply is not just consumables but also printing supplies developed with the Komori Graphic Technology Center (KGC) for high print quality and performance.

All exhibit presses will use K-Supply. K-Supply ink is the Komori standard H-UV ink offering high-level hardness, print quality, versatility and economical performance.

At the exhibition site, products that contribute to energy saving on existing machines and in the plant, such as DC blowers and a real-time operations monitor (power consumption monitoring device) will also be shown.

(Availability depends on area.)

KOMORI Ecology Corner

‘Building a mild, bright future where the balance is protected through the coexistence of everything’ is the green concept that Komori promotes. We will introduce the building of production environments that incorporate this green concept as well as the current state of product development.

Web Offset/Chambon Corner

Komori developed H-UV-equipped presses to respond to the need to apply H-UV technology to web offset presses and has been working on further printing technology innovation. Since H-UV was announced, more than 600 offset presses equipped with this system have been put into operation around the world (as of December 31, 2015). Now H-UV is a system that now provides powerful support for printers’ business by meeting the need for ultra-short turnaround times and extremely short runs through instant curing and powderless printing that solves the problems inherent to printing with conventional ink.

H-UV is now being used for not only sheetfed but also web offset presses, resulting in high performance machines that combine sheetfed print quality that is unaffected by the dryer and the high production capability of web offset.

At drupa, we will show printing samples from an H-UV-equipped web offset press and comparison samples from an H-UV-equipped sheetfed and a conventional web offset machine using the same image, allowing visitors to confirm H-UV print quality. Panels showing the in-line presses for packaging manufactured by Komori-Chambon and printing samples will also be introduced.

Print Gallery

An array of diverse high added value printed items from around the world. Display of various highly competitive printed products that use special techniques and inspire new business models along with an introduction to a wide variety of printing methods.

LITHRONE GX40

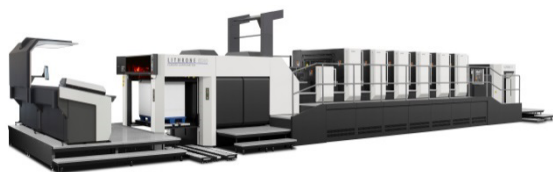

GLX-640+C+H-UV

LITHRONE GX40RP



GLX-840RP+H-UV

LITHRONE G37



GL-437+H-UV L (LED)

LITHRONE G29



GL-529+C+H-UV

Apressia CT137



Impremia IS29



Impremia NS40

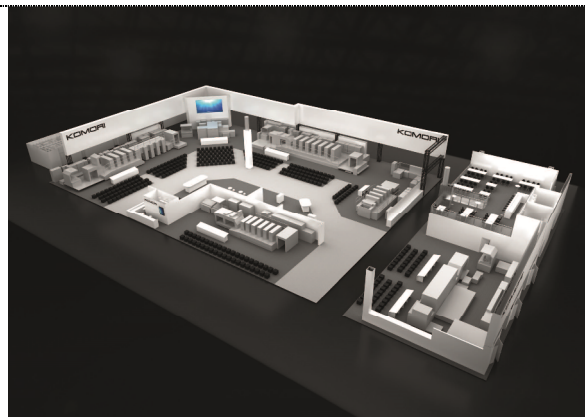

*Exhibition content is subject to change. Please be understanding of this beforehand.

= drupa2016 KOMORI Special Website =
<http://www.komori-event.com/drupa2016/en>

drupa 2016: Count on seeing the best at the Komori booth. We look forward to seeing you.